



TLJ Switchgear

Simotrol AS/NZS 61439 Power Distribution Motor Control Centre

SWITCHBOARD MANUFACTURING | SYSTEM INTEGRATION | HV INDUSTRY

Simotrol: Power Distribution Motor Control Centre

Simotrol is a self-supporting industrial rated switchboard system employing a modular tiered design. It's versatility and innovation caters for a range of industrial applications.

Simotrol is AS/NZS 61439 compliant

Independent laboratory verification has fully certified Simotrol as meeting all the requirements of AS/NZS 61439 for low voltage switchgear and control gear assemblies.

Construction

Simotrol is constructed from 2mm folded sheet metal. Equipment, busbar and cabling compartments are fully segregated to form 3b/4a assuring operator, asset and maintenance safety. The default finish is RAL 7035 grey ripple polyester powder coat with white interior. (Alternate colours are available on request).

Evolving standards, technological advances and improvements in the manufacturing and tooling processes are all accommodated, with a focus on ensuring that the switchboard design remains fully backward compatible.

Tier's

Two tier heights are available at 1980mm and 2200mm and (custom heights available on request). Standard depths are 450mm for single sided front access and 750mm double sided (back to back).

The bolted sheetmetal fabrication ensures additional tiers can be added without cutting, welding or drilling.

Busbars

Busbar positions are standardised and clamped with verified supports. Horizontal busbars are housed at the top of each tier in a separate busbar compartment.

Vertical busbars are located in the busbar compartments of each tier extending from top to bottom. There are 2 bar sizes available; 750 amps and 950 amps. For fixed functional units standard design vertical busbars rated to the application are available.

All busbars are tin plated copper. The plating provides both a superb electrical connection and a high corrosion resistance. Access to busbars (if required) is through removable covers located on top of the cubicle.

The cable ways which are run from top to bottom of each tier have integral cable cleats. Non-ferrous gland plates are fitted top and bottom. All access for cable terminations is from the front.

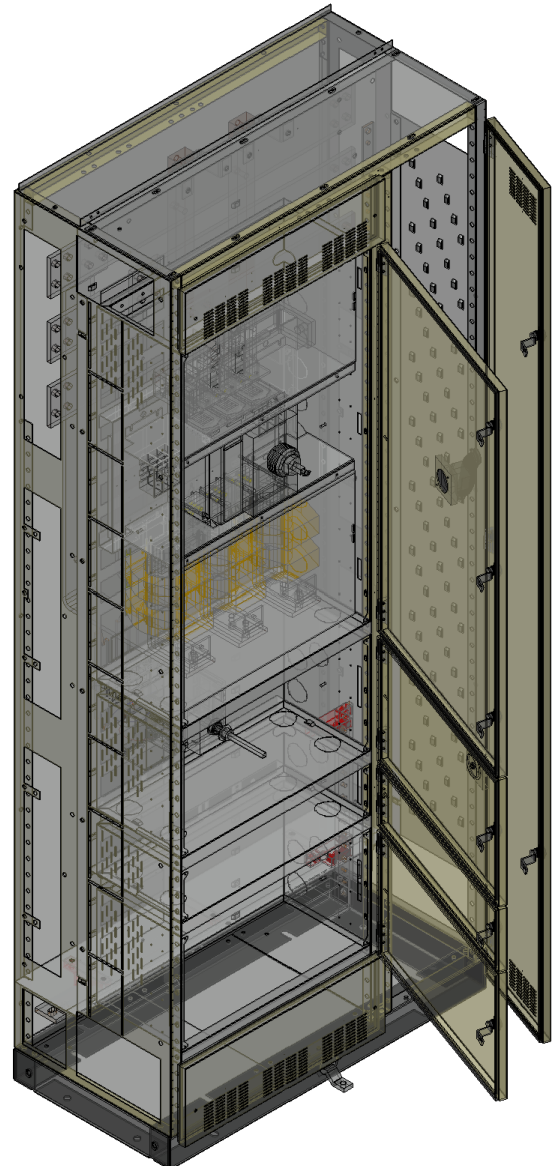

Modules

Functional unit assemblies (modules) consist of a demountable tray and associated door located in the equipment compartments at the accessible face of the switchboard. Functional unit doors are secured with chrome lift-off hinges and ¼ turn lock(s). For operator safety the door is either interlocked with the handle of the isolating device located within ensuring that the door can only be opened in the off position or where an interlock is not available, by means of tool of entry.

Functional unit assemblies are of standardised interchangeable design within their family range and come in modular height increments of 40mm. For demountable functional units $\leq 400\text{A}$, power is distributed from the vertical busbars to each unit through insulated plug contacts. For fixed connection functional units $\geq 630\text{A}$, power is distributed via bolted connections easily accessible at the front of the functional unit. Functional units of the same size are interchangeable. For fixed or withdrawable functional ACB units $\leq 2500\text{A}$, power is distributed via bolted connections at the rear of the functional units.

Technical Data

SIMOTROL Power Distribution Centre is built to comply with AS/NZS 61439.

Rated operating current

- $I_n \leq 2500\text{A}$ @ 0.8 (RDF)

Rated operational voltage

- U_e 415V

Rated Insulation voltage

- U_i 800V
- AS/NZS 61439.1:2016 -10.9.2

Rated impulse voltage

- U_{imp} 8kV
- AS/NZS 61439.1:2016 -10.9.3

Short circuit withstand strength

- I_{cw} 50kA for 1 second – I_{pk} 105kA
- I_{cw} 63kA for 1 second – I_{pk} 139kA
- AS/NZS 61439.1:2016 -10.11

Degree of protection

- $\leq \text{IP54}$
- AS/NZS 61439.1:2016 -10.3

Mechanical impact strength

- IK10
- AS/NZS 61439.1:2016 -10.2.6

Routine verification

- AS/NZS 61439.1:2016 -11

Compliance Data

General Rules

- AS/NZS 61439.1:2016

Power Switchgear and Control Gear Assemblies

- AS/NZS 61439.2:2016

Australian/New Zealand Electrical Wiring Rules

- AS/NZS3000:2007 + A1 + A2

Environmental Test

- IEC 60068-2-30/11

Fire Hazard Test

- AS/NZS 60695.2.11:2001 + A1

Degrees of Protection Provided by Enclosures (IK Code)

- BS EN 62262:2002

Degrees of Protection Provided by Enclosures (IP Code)

- AS60529-2004 (2018)

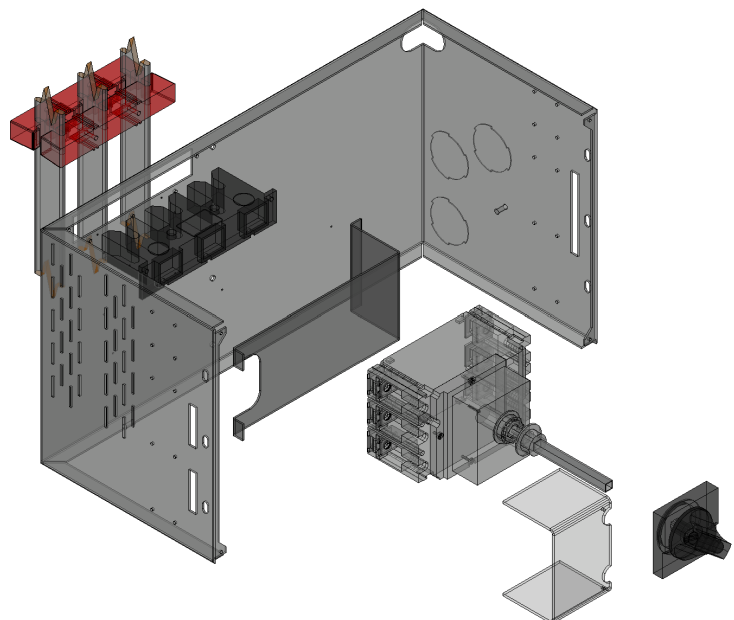



TLJ Switchgear

TL Jones was founded in 1948. In 1992 the Switchgear Division of TL Jones was purchased and their trading name changed to TLJ Switchgear Ltd. TLJ is a name synonymous with the power generation and transmission industries in New Zealand.

TLJ maintain ISO 9001 accreditation and are identified as proven providers of quality-assured switchboard solutions for every sector including commercial, industrial, health, infrastructure, power transmission and generation. TLJ has an in-depth working knowledge of electrical installations and the practicalities required to ensure a fit for purpose switchboard offering.

Switchboards

Main Switchboards, Power and Load Distribution

Motor Control Centre

Forms 1, 2, 3 & 4

Distribution Boards

Mechanical & Electrical Services

HV Generation and Transmission Projects

Protection, Control, Distribution and Communications Panels

Automation

Process and Control, Building Management

Generator Controls

Load Shedding, Synchronisation, Automatic Mains Failure

Application Specific

Custom Design and Build

System Integration

PLC, SCADA, Telemetry, Networking

Engineering

Design, Estimation, HAZOP, CAD

Services

Modifications, Commissioning

TLJ Switchgear

51 Sonter Road Wigram, Christchurch, 8042
+64 (03) 343 4624 | sales@tljswitchgear.co.nz
tljswitchgear.co.nz

